

**Application for a premises licence to be granted
under the Licensing Act 2003**

PLEASE READ THE FOLLOWING INSTRUCTIONS FIRST

Before completing this form please read the guidance notes at the end of the form.
If you are completing this form by hand please write legibly in block capitals. In all cases ensure that your answers are inside the boxes and written in black ink. Use additional sheets if necessary.

You may wish to keep a copy of the completed form for your records.

I/We NIRUPA UNADKAT

(Insert name(s) of applicant)

apply for a premises licence under section 17 of the Licensing Act 2003 for the premises described in Part 1 below (the premises) and I/we are making this application to you as the relevant licensing authority in accordance with section 12 of the Licensing Act 2003

Part 1 – Premises Details

Postal address of premises or, if none, ordnance survey map reference or description ABBEY NEWS 9 HILLHOUSE			
Post town	WALTHAM ABBEY	Post code	EN9 3EL

Telephone number at premises (if any)	01992 651340
Non-domestic rateable value of premises	£6400

Part 2 - Applicant Details

Please state whether you are applying for a premises licence as

Please tick yes

- a) an individual or individuals * please complete section (A)
- b) a person other than an individual *
- i. as a limited company please complete section (B)
- ii. as a partnership please complete section (B)
- iii. as an unincorporated association or please complete section (B)
- iv. other (for example a statutory corporation) please complete section (B)
- c) a recognised club please complete section (B)
- d) a charity please complete section (B)

- e) the proprietor of an educational establishment please complete section (B)
- f) a health service body please complete section (B)
- g) a person who is registered under Part 2 of the Care Standards Act 2000 (c14) in respect of an independent hospital in Wales please complete section (B)
- ga) a person who is registered under Chapter 2 of Part 1 of the Health and Social Care Act 2008 (within the meaning of that Part) in an independent hospital in England please complete section (B)
- h) the chief officer of police of a police force in England and Wales please complete section (B)

* If you are applying as a person described in (a) or (b) please confirm:

Please tick yes

- I am carrying on or proposing to carry on a business which involves the use of the premises for licensable activities; or
- I am making the application pursuant to a
 - statutory function or
 - a function discharged by virtue of Her Majesty's prerogative

(A) INDIVIDUAL APPLICANTS (fill in as applicable)

Mr <input type="checkbox"/>	Mrs <input checked="" type="checkbox"/>	Miss <input type="checkbox"/>	Ms <input type="checkbox"/>	Other Title (for example, Rev)	
Surname UNADKAT			First names NIRUPA		
I am 18 years old or over				<input checked="" type="checkbox"/> Please tick yes	
Current postal address if different from premises address					
Post Town				Postcode	
Daytime contact telephone number		01992 651340			
E-mail address (optional)					

SECOND INDIVIDUAL APPLICANT (if applicable)

Mr <input type="checkbox"/>	Mrs <input type="checkbox"/>	Miss <input type="checkbox"/>	Ms <input type="checkbox"/>	Other Title (for example, Rev)	
Surname			First names		

I am 18 years old or over		<input type="checkbox"/> Please tick yes	
Current postal address if different from premises address			
Post Town		Postcode	
Daytime contact telephone number			
E-mail address (optional)			

(B) OTHER APPLICANTS

Please provide name and registered address of applicant in full. Where appropriate please give any registered number. In the case of a partnership or other joint venture (other than a body corporate), please give the name and address of each party concerned.

Name
Address
Registered number (where applicable)
Description of applicant (for example, partnership, company, unincorporated association etc.)
Telephone number (if any)
E-mail address (optional)

Part 3 Operating Schedule

When do you want the premises licence to start?

Day	Month	Year
2	0	0
9	2	0
1	3	

If you wish the licence to be valid only for a limited period, when do you want it to end?

Day	Month	Year

Please give a general description of the premises (please read guidance note1)
GROUND FLOOR RETAIL UNIT IN A PARADE OF SHOPS

If 5,000 or more people are expected to attend the premises at any one time, please state the number expected to attend.

What licensable activities do you intend to carry on from the premises?

(Please see sections 1 and 14 of the Licensing Act 2003 and Schedules 1 and 2 to the Licensing Act 2003)

Provision of regulated entertainment

Please tick yes

- a) plays (if ticking yes, fill in box A)
- b) films (if ticking yes, fill in box B)
- c) indoor sporting events (if ticking yes, fill in box C)
- d) boxing or wrestling entertainment (if ticking yes, fill in box D)
- e) live music (if ticking yes, fill in box E)
- f) recorded music (if ticking yes, fill in box F)
- g) performances of dance (if ticking yes, fill in box G)
- h) anything of a similar description to that falling within (e), (f) or (g) (if ticking yes, fill in box H)

Provision of entertainment facilities:

- i) making music (if ticking yes, fill in box I)
- j) dancing (if ticking yes, fill in box J)
- k) entertainment of a similar description to that falling within (i) or (j) (if ticking yes, fill in box K)

Provision of late night refreshment (if ticking yes, fill in box L)

Supply of alcohol (if ticking yes, fill in box M)

In all cases complete boxes N, O and P

A

Plays Standard days and timings (please read guidance note 6)			Will the performance of a play take place indoors or outdoors or both – please tick (please read guidance note 2)	Indoors	<input type="checkbox"/>
				Outdoors	<input type="checkbox"/>
				Both	<input type="checkbox"/>
Day	Start	Finish	Please give further details here (please read guidance note 3)		
Mon					
Tue			State any seasonal variations for performing plays (please read guidance note 4)		
Wed					
Thur			Non standard timings. Where you intend to use the premises for the performance of plays at different times to those listed in the column on the left, please list (please read guidance note 5)		
Fri					
Sat					
Sun					

B

Films Standard days and timings (please read guidance note 6)			Will the exhibition of films take place indoors or outdoors or both – please tick (please read guidance note 2)	Indoors	<input type="checkbox"/>
				Outdoors	<input type="checkbox"/>
				Both	<input type="checkbox"/>
Day	Start	Finish	Please give further details here (please read guidance note 3)		
Mon					
Tue			State any seasonal variations for the exhibition of films (please read guidance note 4)		
Wed					
Thur			Non standard timings. Where you intend to use the premises for the exhibition of films at different times to those listed in the column on the left, please list (please read guidance note 5)		
Fri					
Sat					
Sun					

C

Indoor sporting events Standard days and timings (please read guidance note 6)			Please give further details (please read guidance note 3)
Day	Start	Finish	
Mon			
Tue			State any seasonal variations for indoor sporting events (please read guidance note 4)
Wed			
Thur			Non standard timings. Where you intend to use the premises for indoor sporting events at different times to those listed in the column on the left, please list (please read guidance note 5)
Fri			
Sat			
Sun			

D

Boxing or wrestling entertainments Standard days and timings (please read guidance note 6)			Will the boxing or wrestling entertainment take place indoors or outdoors or both – please tick (please read guidance note 2)	Indoors	<input type="checkbox"/>
				Outdoors	<input type="checkbox"/>
				Both	<input type="checkbox"/>
Day	Start	Finish			
Mon			Please give further details here (please read guidance note 3)		
Tue					
Wed			State any seasonal variations for boxing or wrestling entertainment (please read guidance note 4)		
Thur					
Fri			Non standard timings. Where you intend to use the premises for boxing or wrestling entertainment at different times to those listed in the column on the left, please list (please read guidance note 5)		
Sat					
Sun					

E

Live music Standard days and timings (please read guidance note 6)			Will the performance of live music take place indoors or outdoors or both – please tick (please read guidance note 2)	Indoors	<input type="checkbox"/>
				Outdoors	<input type="checkbox"/>
				Both	<input type="checkbox"/>
Day	Start	Finish			
Mon			Please give further details here (please read guidance note 3)		
Tue					
Wed			State any seasonal variations for the performance of live music (please read guidance note 4)		
Thur					
Fri			Non standard timings. Where you intend to use the premises for the performance of live music at different times to those listed in the column on the left, please list (please read guidance note 5)		
Sat					
Sun					

F

Recorded music Standard days and timings (please read guidance note 6)			Will the playing of recorded music take place indoors or outdoors or both – please tick (please read guidance note 2)	Indoors	<input type="checkbox"/>
				Outdoors	<input type="checkbox"/>
				Both	<input type="checkbox"/>
Day	Start	Finish	Please give further details here (please read guidance note 3)		
Mon					
Tue			State any seasonal variations for the playing of recorded music (please read guidance note 4)		
Wed					
Thur			Non standard timings. Where you intend to use the premises for the playing of recorded music at different times to those listed in the column on the left, please list (please read guidance note 5)		
Fri					
Sat					
Sun					

G

Performances of dance Standard days and timings (please read guidance note 6)			Will the performance of dance take place indoors or outdoors or both – please tick (please read guidance note 2)	Indoors	<input type="checkbox"/>
Day	Start	Finish		Outdoors	<input type="checkbox"/>
Mon			Please give further details here (please read guidance note 3)	Both	<input type="checkbox"/>
Tue					
Wed			State any seasonal variations for the performance of dance (please read guidance note 4)		
Thur					
Fri			Non standard timings. Where you intend to use the premises for the performance of dance at different times to those listed in the column on the left, please list (please read guidance note 5)		
Sat					
Sun					

H

Anything of a similar description to that falling within (e), (f) or (g) Standard days and timings (please read guidance note 6)			Please give a description of the type of entertainment you will be providing		
Day	Start	Finish	Will this entertainment take place indoors or outdoors or both – please tick (please read guidance note 2)	Indoors	<input type="checkbox"/>
Mon				Outdoors	<input type="checkbox"/>
				Both	<input type="checkbox"/>
Tue			Please give further details here (please read guidance note 3)		
Wed					
Thur			State any seasonal variations for entertainment of a similar description to that falling within (e), (f) or (g) (please read guidance note 4)		
Fri					
Sat			Non standard timings. Where you intend to use the premises for the entertainment of a similar description to that falling within (e), (f) or (g) at different times to those listed in the column on the left, please list (please read guidance note 5)		
Sun					

Provision of facilities for making music Standard days and timings (please read guidance note 6)			Please give a description of the facilities for making music you will be providing	
			Will the facilities for making music be indoors or outdoors or both – please tick (please read guidance note 2)	
			Indoors	<input type="checkbox"/>
			Outdoors	<input type="checkbox"/>
			Both	<input type="checkbox"/>
Day	Start	Finish	Please give further details here (please read guidance note 3)	
Mon				
Tue				
Wed				
Thur				
Fri				
Sat				
			State any seasonal variations for the provision of facilities for making music (please read guidance note 4)	
			Non standard timings. Where you intend to use the premises for provision of facilities for making music at different times to those listed in the column on the left, please list (please read guidance note 5)	
Sun				

J

Provision of facilities for dancing Standard days and timings (please read guidance note 6)			Will the facilities for dancing be indoors or outdoors or both – please tick (see guidance note 2)	Indoors	<input type="checkbox"/>
				Outdoors	<input type="checkbox"/>
				Both	<input type="checkbox"/>
			Please give a description of the facilities for dancing you will be providing		
Day	Start	Finish			
Mon			Please give further details here (please read guidance note 3)		
Tue					
Wed			State any seasonal variations for providing dancing facilities (please read guidance note 4)		
Thur					
Fri			Non standard timings. Where you intend to use the premises for the provision of facilities for dancing entertainment at different times to those listed in the column on the left, please list (please read guidance note 5)		
Sat					
Sun					

K

Provision of facilities for entertainment of a similar description to that falling within i or j Standard days and timings (please read guidance note 6)			<u>Please give a description of the type of entertainment facility you will be providing</u>		
Day	Start	Finish	<u>Will the entertainment facility be indoors or outdoors or both – please tick</u> (please read guidance note 2)	Indoors	<input type="checkbox"/>
Mon				Outdoors	<input type="checkbox"/>
				Both	<input type="checkbox"/>
Tue			<u>Please give further details here</u> (please read guidance note 3)		
Wed					
Thur			<u>State any seasonal variations for the provision of facilities for entertainment of a similar description to that falling within i or j</u> (please read guidance note 4)		
Fri					
Sat			<u>Non standard timings. Where you intend to use the premises for the provision of facilities for entertainment of a similar description to that falling within i or j at different times to those listed in the column on the left, please list</u> (please read guidance note 5)		
Sun					

L

Late night refreshment Standard days and timings (please read guidance note 6)			Will the provision of late night refreshment take place indoors or outdoors or both – please tick (please read guidance note 2)	Indoors	<input type="checkbox"/>
				Outdoors	<input type="checkbox"/>
				Both	<input type="checkbox"/>
Day	Start	Finish			
Mon			Please give further details here (please read guidance note 3)		
Tue			State any seasonal variations for the provision of late night refreshment (please read guidance note 4)		
Wed			Non standard timings. Where you intend to use the premises for the provision of late night refreshment at different times, to those listed in the column on the left, please list (please read guidance note 5)		
Thur					
Fri					
Sat					
Sun					

M

Supply of alcohol Standard days and timings (please read guidance note 6)			Will the supply of alcohol be for consumption (Please tick box) (please read guidance note 7)	On the premises	<input type="checkbox"/>
				Off the premises	<input checked="" type="checkbox"/>
				Both	<input type="checkbox"/>
Day	Start	Finish	State any seasonal variations for the supply of alcohol (please read guidance note 4)		
Mon	06.30	22.00			
Tue	06.30	22.00			
Wed	06.30	22.00			
Thur	06.30	22.00			
Fri	06.30	22.00			
Sat	06.30	22.00			
Sun	06.30	22.00			
			Non standard timings. Where you intend to use the premises for the supply of alcohol at different times to those listed in the column on the left, please list (please read guidance note 5)		

State the name and details of the individual whom you wish to specify on the licence as premises supervisor

Name	NIRUPA UNADKAT
Address	9 HILLHOUSE WALTHAM ABEY
Postcode	EN9 3EL
Personal Licence number (if known)	BEING APPLIED FOR
Issuing licensing authority (if known)	EPPING COUNCIL

N

Please highlight any adult entertainment or services, activities, other entertainment or matters ancillary to the use of the premises that may give rise to concern in respect of children (please read guidance note 8)

NONE

O

Hours premises are open to the public Standard days and timings (please read guidance note 6)			State any seasonal variations (please read guidance note 4)
Day	Start	Finish	
Mon	06.30	22.00	<p>Non standard timings. Where you intend the premises to be open to the public at different times from those listed in the column on the left, please list (please read guidance note 5)</p>
Tue	06.30	22.00	
Wed	06.30	22.00	
Thur	06.30	22.00	
Fri	06.30	22.00	
Sat	06.30	22.00	
Sun	06.30	22.00	

Consent of individual to being specified as premises supervisor

*I NIRUPA UNADKAT
[full name of prospective premises supervisor]

*of 9 Hillhouse
Waltham Abbey
EN9 3EL
[home address of prospective premises supervisor]

hereby confirm that I give my consent to be specified as the designated premises supervisor in relation to the application for

NEW APPLICATION
[type of application]

by NIRUPA UNADKAT
[name of applicant]

relating to a premises licence NEW APPLICATION
[number of existing licence, if any]

for 9 Hillhouse
Waltham Abbey
Essex EN9 3EL
[name and address of premises to which the application relates]

and any premises licence to be granted or varied in respect of this application made by

NIRUPA UNADKAT
[name of applicant]

concerning the supply of alcohol at 9 Hillhouse
Waltham Abbey
Essex EN9 3EL
[name and address of premises to which application relates].

I also confirm that I am applying for, intend to apply for or currently hold a personal licence, details of which I set out below.

* Personal licence number Denia Appus for
[insert personal licence number, if any]

* Personal licence issuing authority Essex Police DC
[insert name and address and telephone number of personal licence issuing authority, if any]

.....signed date of birth 18/10/1949 *

* [redacted] full name (please print)

* 28/7/2013 dated place of birth UGANDA *
(town and country)

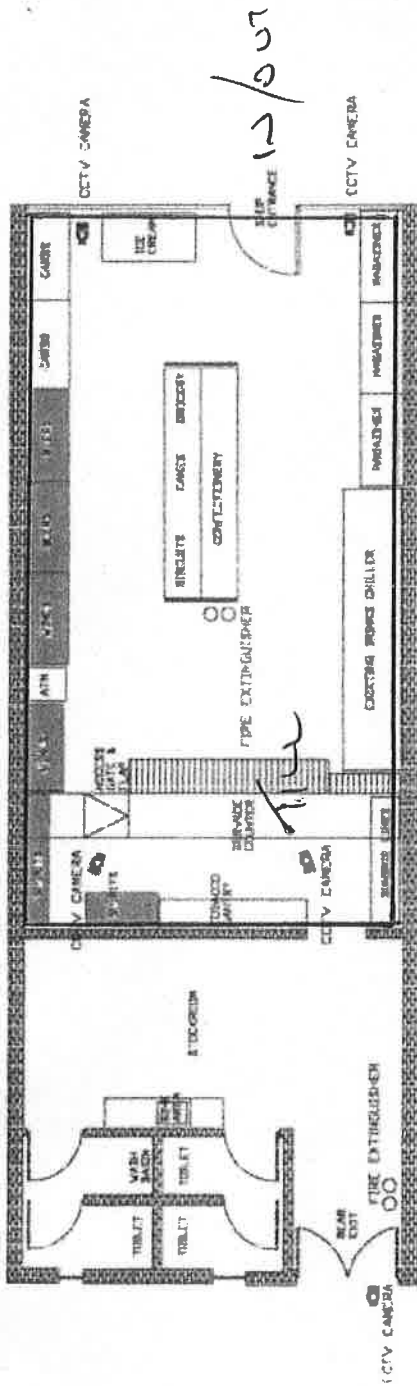

ALCOHOL DISPLAY THROUGHOUT SHOP
 WITHIN RAS DOORWAY.
 Scale 1:100

- CCTV CAMERA
- FIRE EXTINGUISHER
- SELF SERVICE AREA

THREATENED	NAME	DATE
MR P KUMAR	MR P KUMAR	17/2/2005
ABBAY NEWS	ABBAY NEWS	
9 HILL HOUSE	9 HILL HOUSE	
NINEFELLS	NINEFELLS	
UPSHIRE, ESSEX	UPSHIRE, ESSEX	
EN9 3EL	EN9 3EL	

THIS DRAWING IS THE PROPERTY OF VEEDAY ASSOCIATES AND MUST NOT BE COPIED OR REPRODUCED EXCEPT WITH THE EXPRESS PERMISSION NOR MAY THE DESIGN OR ANY INFORMATION SHOWN THEREON BE DISCLOSED TO ANY THIRD PARTY.

VEEDAY.CO.UK

SHOPFITTING CONSULTANTS
 10 CANNON ROAD, THAMES VALLEY, UOXLEY, MIDDLESEX, M20 9BQ
 TEL/FAX 01279 810290
 MOBILE NO 07831 071343

DATE 17/2/2005
 DRAWN BY 17/2/2005

Gardener's Plot

Fencing Services

ESSEX FENCING

For all your fencing needs
Supply & erect all types of fencing.
For a friendly FREE quote call Ricky on
Mob. 07930 424045
Office. 01375 407847
www.essexfencingltd.com
ricky@essexfencingltd.com

Gardening Maintenance

Garden Service Ltd

Garden Creators
**Patios, Decking, Brick walls, Turf
Fences, Driveways, Tidy ups**
Call 020 3174 1619
Or Freephone 0800 232 1877
Or Paul on 07980 390 824
www.gardencreators.co.uk

KJ GARDENING SERVICES

Ride on mower for larger gardens
Fully licenced waste carrier
Full Garden Maintenance Service
Client References available
**Contact Beau 07947 807900
After 6pm 020 8498 0592**
www.kjgardening.co.uk | Public Liability Insurance

ALL GARDEN Landscaping & Building Services, trusted & reliable, Free quotes, testimonials & portfolio. Call Neil

GRASS CUTTING, hedge trimming & all garden work undertaken. Call 07779

Gardening Maintenance

TAYLOR TREE CARE

All Types of trees Expertly
• Felled • Pruned • Shaping
• Stumps Ground Out
• Overgrown Gardens Cleared • Fencing
Free Quotes
**0208 485 9279
07769 313 080**

AK FENCING AK LANDSCAPING

10 yrs. exp.
All types of fencing supplied and fitted. Also garden turfing, Decking, Block paving and Patios. New Pressure Treated Railway Sleepers £20
FREE ESTIMATES AND ADVICE
**0208418 9788
07973 439226**
www.akfencing-landscaping.co.uk

M & D Home Improvements

Patios • Fencing
Turfing • Concrete
Garden walls & sheds
Roofing and Guttering
All repair work undertaken
FREE ESTIMATES
**020 8485 9543
07402 153677**
No deposit needed

Public Notices

PUBLIC NOTICE OF AN APPLICATION FOR A PREMISES LICENCE UNDER SECTION 17 OF THE LICENSING ACT 2003

Notice is hereby given that an application was made to Epping Forest District Council for a premises licence under the above Act on the 23rd August 2013. Applicant: Nirupa Unadkat. Address of premises: Abbey News 9 Hillhouse, Waltham Abbey, EN9 3EL. Proposed licensable activities: Sale of alcohol for consumption on the premises. Proposed days and hours of licensable activity: Every day Alcohol Sales 06.00 to 21.00. The postal address of the Licensing Authority where the register is kept and the application may be inspected is: Epping Forest District Council, Licensing Unit, Civic Offices, High Street, Epping, Essex CM16 4BZ.

Any person wishing to make representations on this matter shall give notice, in writing, stating the nature and grounds for making such representations, to the Licensing Officer at the above address within 28 days of the date of this notice - by the 20th September 2013. Further information is available on the web site www.eppingforest.gov.uk following the links. It is an offence under section 158 of the Licensing Act 2003, to knowingly or recklessly make a false statement in or in connection with an application and the maximum fine on summary conviction of such an offence is £5000. Licensing Solutions - duty author-ised agents

Public Notices

JOAN LELIA SHELTON (Deceased)
Pursuant to the Trustee Act 1925 any persons having a claim against or an interest in the Estate of the aforementioned deceased, late of 5, Eucor Road Luton LU1 1RQ, E10 6DS, who died on 21/08/2011, are required to send particulars of such claim or interest to the undersigned, Solicitor, on or before 15/11/2013, after which date the Estate will be distributed having regard only to claims and interests of which they have had notice.

ADAMS SOLICITORS
129 Mile End Road
London E1 4BG
7389855

PAUL CAVELL NORTHAM (Deceased)
Pursuant to the Trustee Act 1925 any persons having a claim against or an interest in the Estate of the aforementioned deceased, late of 1 The Lodge The Plain Epping, Essex, CM16 6TF, who died on 06/08/2012, are required to send particulars thereof to the undersigned on or before 15/11/2013, after which date the Estate will be distributed having regard only to claims and interests of which they have had notice.

WILSONS SOLICITORS
Alexandra House St Johns Street
Salisbury Wiltshire SP1 2SB
7389633

RONALD IAN GRINDLEY (Deceased)
Pursuant to the Trustee Act 1925 any persons having a claim against or an interest in the Estate of the aforementioned deceased, late of Flat 12 London, E17 1LH, who died on 27/04/2013, are required to send particulars thereof in writing to the undersigned on or before 15/11/2013, after which date the Estate will be distributed having regard only to claims and interests of which they have had notice.

THE CO-OPERATIVE LEGAL SERVICES LIMITED
Acting: 660 Acrea West
Innardsbury Estate BS32 4SD
(Tel: 01453744887/0nday) 738249

You're one click away...
Ads247
Online booking day or night
www.guardian-series.co.uk/ads247

clear out that clutter!
Articles for sale under £100 FREE if advertised through our website
***Reach 165,758 readers per week!**
guardian-series.co.uk/ads247
*Source: ICMREG, Webstatibus Oct08

SKILL
All skills available
Friendly, reliable service.
Tel: **020 8529 6902
07966 433791**
www.essexionskiphire.com

TOWN SKIPS
Excellent Prices & Service.
All Areas Covered.
Same Day
020 8887 6867
townskips@aol.co.uk

Fast Rental Service
Excellent Rates
020 8807 5948

PUBLIC NOTICE OF AN APPLICATION FOR A PREMISES LICENCE UNDER SECTION 17 OF THE LICENSING ACT 2003

Notice is hereby given that an application was made to **EPPING FOREST DISTRICT COUNCIL** for a premises licence under the above Act on the **23RD AUGUST 2013**.

Applicant: **NIRUPA UNADKAT**

Address of premises: **ABBAY NEWS
9 HILLHOUSE
WALTHAM ABBEY
EN9 3EL**

Proposed licensable activities:

**SALE OF ALCOHOL
FOR CONSUMPTION OFF THE PREMISES**

Proposed days and hours of licensable activity:

EVERY DAY

ALCOHOL SALES 06.30 TO 22.00

The postal address of the Licensing Authority where the register is kept and the application may be inspected is:

***EPPING FOREST DISTRICT COUNCIL,
LICENSING UNIT, CIVIC OFFICES, HIGH STREET,
EPPING, ESSEX CM16 4BZ**

Any person wishing to make representations on this matter shall give notice, in writing, stating the nature and grounds for making such representations to The Licensing Officer at the above address* within 28 days of the date of this notice – by the **20th September 2013**.

Further information is available on the web site www.eppingforestdc.gov.uk following the links. It is an offence, under section 158 of the Licensing Act 2003, to knowingly or recklessly make a false statement in or in connection with an application, and the maximum fine on summary conviction of such an offence is £5000.

Licensing Solutions – duly authorised agents



Licensing Department, Epping Police Station
230 High Street, Epping, CM16 4AP
Telephone 01279 625 405 Facsimile: 01279 625 440
Website: www.essex.police.uk Email: Peter.Jones@essex.pnn.police.uk

Mrs Kim Tuckey
Licensing Department
Epping Forest District Council
Civic Offices
High Street
Epping
CM16 4BZ

4 September 2013

Dear Kim,

LICENSING ACT 2003 – GRANT OF PREMISES LICENCE SECTION 17
NEW PREMISE: Abbey News, 9 Hill House, Waltham Abbey
DPS: Nirupa UNADKAT (Personal Licence Pending)
APPLICANT: Nirupa UNADKAT via Licensing Solutions

Further to the above application for the Grant of a Premises Licence received on 23 August 2013. I can now confirm that all my checks have been carried out and can confirm that Essex Police will not be making any representations or objections to this application in respect of the licensing objectives.

I trust the aforementioned will assist and look forward to receiving a copy of the Licence, if/when processed, in due course.

Yours sincerely,

Mr Peter Jones ABII
Epping & Brentwood Licensing Officer
West LPA

Cc. **Licensing Solutions**
235 Botley Road
BurrIDGE
Southampton
Hampshire
SO31 1BJ

Joanne Owen

From: Chris Mitchener <licensingolutions@live.co.uk>
Sent: 03 September 2013 17:59
To: Peter Jones
Cc: solutions@licensingolutions.org.uk; Licensing
Subject: Re: Premises Licence Application - Abbey News, 9 Hill House, Waltham Abbey

Hi Peter

I am so sorry for confusion it is C25 !

CCTV is installed four cameras effectively one in each corner !

regards

Chris

On 3 Sep 2013, at 12:40, Peter Jones <Peter.Jones@essex.pnn.police.uk> wrote:

Good Afternoon,

I am the Police Licensing Officer dealing with the above application.

I have gone through the application, and have the following questions:

1. In Section P there is reference to Challenge 21 and Challenge 25. Please can you advise which initiative is to be used?
2. Do the premises have CCTV installed, or intend to? I am not seeking to condition it, but would like to make reference on our database, in case incidents occur.

I look forward to your response.

Kind Regards

Peter Jones ABII (7706)

Epping & Brentwood Licensing Officer

West LPA

 Tel. 01279 625405 or 101 (Ext. 318175)

 Fax. 01279 625440 (Int. 318335)

 Peter.Jones@essex.pnn.police.uk

 www.essex.police.uk

 Epping Police Station

230 High Street

Epping

CM16 4AP

To find out what is happening in your neighbourhood and all about your local neighbourhood policing team visit www.essex.police.uk/yourarea and enter your postcode.

Essex County Fire & Rescue Service

Mr David Johnson LL.B(Hons), BSc, MA, MSc, FCFI
Chief Fire Officer & Chief Executive



District Planning Officer
Epping Forest District Council
Civic Offices, High Street
EPPING
Essex
CM16 4BZ

WEST AREA COMMAND
Harlow Service Delivery Point
Fourth Avenue
HARLOW
CM20 1DU
☎ 01279 420841
✉ he.command@essex-fire.gov.uk

Date: 22nd August 2013
Our Ref: FP/73/6930
Enquiries to: Geoff Marler
Workplace Fire Safety Officer

Dear Sir/Madam,

LICENSING ACT 2003
THE REGULATORY REFORM (FIRE SAFETY) ORDER 2005
Premises: Abbey News, 9 Hillhouse, Waltham Abbey, EN9 3EL

Receipt is acknowledged of the above consultation, which will be audited by the Essex Fire Authority (The Authority).

Should there be any significant concerns regarding the application you will be notified in due course.

Yours faithfully

Geoff Marler
Fire Safety Officer

Licensing Applications
Children's Safeguarding Service
Schools Children's and Families Service
A Block 202, County Hall
Chelmsford CM1 1YS
Tel: 01245 436744
Email: LicenceApplications@essex.gov.uk



Chris Mitchener
Licensing Solutions
235 Botley Road
Burridge
Southampton, SO31 1BJ

Our ref: 08-2013/26
Date: 28 August 2013

Dear Chris

RE: Licensing Act 2003: Abbey News, 9 Hillhouse, Waltham Abbey, EN9 3EL

The licensing application received on 22nd August 2013 has been assessed and we can confirm we have no objections to this licence application.

Yours sincerely

A handwritten signature consisting of several overlapping horizontal and diagonal lines.

Paula Stacey
Service Manager Safeguards,
Children's Safeguarding Service



INVESTOR IN PEOPLE



2002-2003
Adaptation
2005-2008
Integrated Children's Services

EssexWorks.

For a better quality of life

Joanne Owen

From: michelle smith
Sent: 18 September 2013 20:12
To: Licensing
Subject: Abbey News - Applying for an Alcohol Licence

To whom it may concern

I have just been informed that Abbey News Hillhouse Waltham Abbey Essex EN9 3EL have applied for an alcohol licence between 6:30am-10pm. I think this is going to cause enormous problems. My children go to Hillhouse school and we are always over the shops and we are finding more and more people hanging around the shops, some drinking and swearing . Mann Bros already sell alcohol until 10pm so why on earth do they need to sell it as early as 6:30am this is just asking for trouble.

Please reconsider this application.

Many thanks

Mrs Michelle Smith

Mann Bros Supermarket
1-4 Hill House
Waltham Abbey
EN9 3EL

Thursday 5th September 2013

Your Ref: Abbey News

To whom it may concern,

I am writing to make a representation AGAINST the application for the sale of alcohol at Abbey News.

Eventhough the application has been made by Mrs Nirupa Unadkat, the business is actually run by both herself and her husband at all times

We have 15 years of experience and know how to deal with many difficult situations when it comes to alcohol selling such as abusive language and aggressive behavior from customers. The local community and we feel that taking into the consideration the age of the applicant and that they will not be able to handle these situations. As they will not be able to handle the local teenagers this will only lead to more crime and anti social behavior in the area.

Without a doubt, this will also have a negative impact on our business and as the council is trying to increase our rent, this will leave us in a very difficult position. There are already far too many Off Licenses within Waltham Abbey i.e. in the last 10 years Tesco, Lidl, Home Bargains, Abbey Express and other outlets have openend.

Please take these points into consideration in this application.

Yours sincere



Epping Forest District Council

Civic Offices
High Street
Epping CM16 4BZ

Abbey News
9 Hillhouse

Centre X: 539846.000

Centre Y: 200545.000

Width : 225.000

Angle : .000

Scale : 1:1250

Date : 25 Sep 2013

Time : 10:53:15 AM

Contains Ordnance Survey & Royal Mail Data © Crown Copyright & Database Right 2012, EFDC License No: 100018534 2012 © Royal Mail Copyright & Database Right 2012, © Environment Agency, © Copyright Geo Perspectives, © Natural England 2012, Reproduced with the permission of Natural England

